



Adjustable Putter Bending Tool

A new and improved version of a great tool for altering the lie and loft on hosel-less putters fitted with either straight or double bend putter shafts.

The putter head can now be easily secured with the non marring top clamp with the shaft nested in the height adjustable supporting sheave which directs and distribute bending pressure over a wider bending radius. This prevents the shaft from denting or collapsing under pressure.

The putter bending tool is best mounted at a 45 degree angle to the corner of a work bench as shown. This will make bending both right-hand and left-hand putters possible when changing over from RH to LH configuration

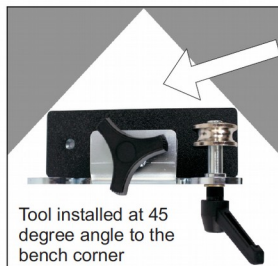

Tool installed at 45 degree angle to the bench corner

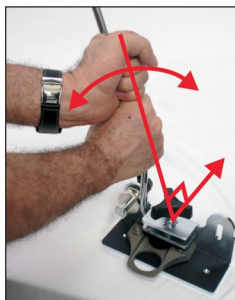

Loft angle alteration:
Grasp the shaft with both hands fist to fist at the lowest possible point.

To increase the loft angle Pull on the shaft perpendicular to the putter face.

To decrease the loft angle; Push the shaft perpendicular to the putter face

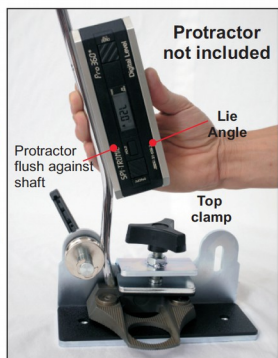

Protractor not included

Protractor flush against shaft
Lie Angle
Top clamp

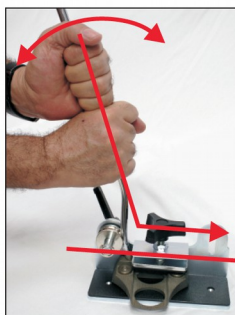

Lie angle alteration:
Grasp the shaft with both hands fist to fist at the lowest point.

To flatten the lie angle pull away in the same plane as the putter face.

To make the lie angle more upright push towards and in the same plane as the putter face